

AMERISTAR[®]

CASINO ★ RESORT ★ SPA

— ST. CHARLES —

HOTEL SUITES



This all-suite facility features 397 hotel suites; 385 standard premium suites, ten executive suites and two presidential suites. Suites feature sunken living rooms with floor-to-ceiling windows showcasing views of the Missouri River or the historic city of St. Charles. Suites include luxury furnishings, premium mattresses, plush linens, flat-screen televisions, in-room safes, double vanities, separate tubs and showers with premium bath products. Rooms fully renovated in December 2024.

STANDARD PREMIUM SUITE

- Approximately 650 square feet
- Sunken living room
- Coffee maker
- Safe
- Multiple televisions
- Glass shower
- Separate tub
- Granite finishings
- Bottled water
- Mini refrigerator

PRESIDENTIAL SUITE

- Approximately 1,800 square feet
- Separate bedroom from living room
- Complete living room with dining table
- Full-sized pool table
- Butler's pantry with fridge
- Full wet bar
- Full fireplace
- Multiple televisions

EXECUTIVE SUITE

- Approximately 1,200 square feet
- Separate bedroom from living room
- Multiple televisions
- Large full bathroom with walk-in shower
- Second half bathroom



AMERISTAR CASINO RESORT SPA

AMENITIES



SWIMMING POOL DECK

Indoor-outdoor swimming pool deck featuring fountains, a fire pit, and whirlpools.

This feature is open seasonally.

FULL-SERVICE SPA

Treat yourself to unparalleled relaxation at our full-service spa featuring massage therapy, facials, nail salon, sauna, hot tub, and steam room.

Sunday | 10:00am - 4:00pm

Monday | 9:00am - 6:00pm

Tuesday - Wednesday | CLOSED

Thursday | 9:00am - 6:00pm

Friday - Saturday | 9:00am - 7:00pm

FITNESS CENTER

An adjoining fitness center with cardiovascular and strength-training machines is available to all hotel guests 24 hours a day with a hotel key card.

CONFERENCE CENTER



Ameristar Casino Resort Spa St. Charles features 22,000 square feet of the most complete meeting and event facilities in the Greater St. Louis Region. We offer a traditional conference center, spacious and versatile rooms and customized services. Our Conference Center expansion will add 40,000 square feet of traditional meeting space featuring a 16,000 square foot ballroom with state-of-the-art audio visual. Opening in Fall of 2025!

FEATURES

- Traditional and non-traditional meeting spaces
- Venues for entertaining
- Encore Global audio visual services
- Wireless internet in hotel guest rooms and meeting spaces
- Self parking in covered garage with 6,100 spaces
- Direct access from the parking garage

DISCOVERY LEVEL

DISCOVERY BALLROOM

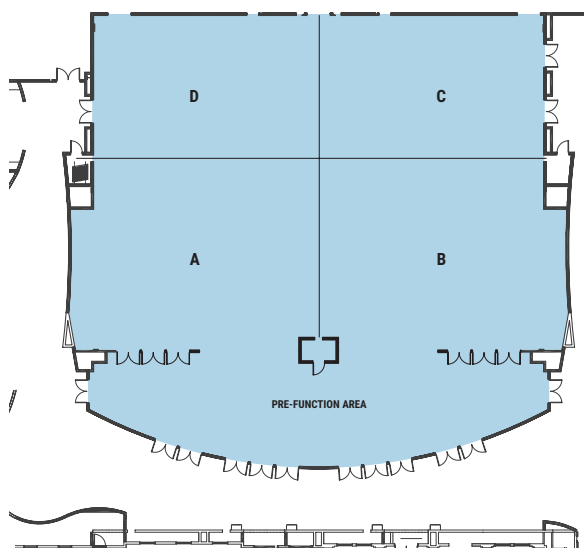

MEETING ROOMS

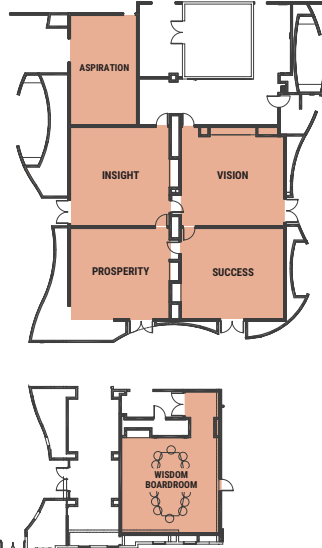

IMAGINATION ROOM

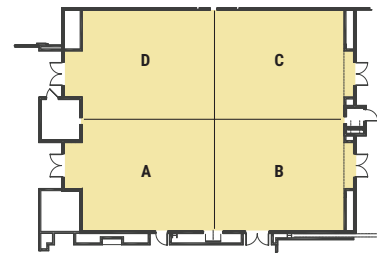

* See next page for each conference room detail breakdown.

CAPACITIES



DISCOVERY LEVEL

Discovery Ballroom

Room Name	Square Footage	W x L	Ceiling Height	Classroom Style	Theater Style	Hollow Style	U-Shape	Banquet Seat 8	Banquet Seat 10	Reception	10 x 10 Exhibits
Pre-function Area	2,808	117' x 24'	14'	-	-	-	-	-	-	-	-
Main Ballroom <i>(Functional Space)</i>	9,828	117' x 84'	20'	578	1229	N/A	N/A	560	700	1450	45
Main Ballroom <i>(Total Square Footage)</i>	11,817	117' x 101'	20' to 23'	700	1300	N/A	N/A	560	850	1600	60
Ballroom A	2,726	58' x 47'	20' to 23'	160	341	68	94	120	150	300	15
Ballroom B	2,726	58' x 47'	20' to 23'	160	341	68	94	120	150	300	15
Ballroom C	1,961	53' x 37'	20' to 23'	115	245	49	68	80	100	250	8
Ballroom D	1,961	53' x 37'	20' to 23'	115	245	49	68	80	100	250	8
Ballroom A/D	4,698	58' x 81'	20' to 23'	276	587	117	162	240	300	700	23
Ballroom B/C	4,698	58' x 81'	20' to 23'	276	587	117	162	240	300	700	23

Imagination Room

Room Name	Square Footage	W x L	Ceiling Height	Classroom Style	Theater Style	Hollow Style	U-Shape	Crescents of 8	Banquet Seat 10	Reception	10 x 10 Exhibits
Main Ballroom	3,876	68' x 57'	13' to 14'	228	485	97	134	224	280	580	26
Ballroom A	952	34' x 28'	13' to 14'	56	119	24	33	48	60	100	4
Ballroom B	952	34' x 28'	13' to 14'	56	119	24	33	48	60	100	4
Ballroom C	952	34' x 28'	13' to 14'	56	119	24	33	48	60	100	4
Ballroom D	952	34' x 28'	13' to 14'	56	119	24	33	48	60	100	4
Ballroom A/D	1,904	34' x 56'	13' to 14'	112	238	48	66	104	130	250	10
Ballroom B/C	1,904	34' x 56'	13' to 14'	112	238	48	66	104	130	250	10

Meeting Rooms

Room Name	Square Footage	W x L	Ceiling Height	Classroom Style	Theater Style	Hollow Style	U-Shape	Crescents of 8	Banquet Seat 10	Reception	10 x 10 Exhibits
Aspiration	476	17' x 28'	11'6"	28	60	12	16	24	30	33	2
Insight	625	25' x 25'	11'6"	37	78	16	22	32	40	44	4
Prosperity	575	25' x 23'	11'6"	34	72	14	20	32	40	38	4
Success	598	26' x 23'	11'6"	35	75	15	21	32	40	42	4
Vision	598	26' x 23'	11'6"	35	75	15	21	32	40	42	4
Wisdom Boardroom	676	25' x 26'	9'6"	N/A	N/A	17	N/A	N/A	N/A	N/A	N/A

CAPACITIES



BRILLIANCE LEVEL

Room Name	Square Footage	W x L	Ceiling Height	Classroom Style	Theater Style	Hollow Style	U-Shape	Banquet Seat 8	Banquet Seat 10	Reception	10 x 10 Exhibits
Pre-function	9,880	-	-	-	-	-	-	-	-	-	-
Brilliance Stage	975	18' x 55'	16'	-	-	-	-	-	-	-	-
Brilliance Ballroom	15,653	116' x 136'	19'	921	1,957	N/A	N/A	896	1,120	2,236	91
Wonder Ballroom	5,078	60' x 85'	17'	299	635	127	175	288	360	725	30
Ambition Boardroom	660	30' x 22'	16'	N/A	N/A	17	N/A	N/A	N/A	N/A	N/A
Excellence	2,351	38' x 63'	16'	138	294	59	81	136	170	336	14
Integrity	1,163	31' x 38'	16'	68	145	29	40	72	80	166	7
Clarity	1,163	31' x 38'	16'	68	145	29	40	72	80	166	7
Achievement	979	29' x 34'	16'	58	122	24	34	56	70	140	6
Office	180	7' x 25'	16'	-	-	-	-	-	-	-	-
Welcome Desk	459	-	-	-	-	-	-	-	-	-	-



NON-TRADITIONAL MEETING SPACES



RYSE NIGHTCLUB

- Private lounge or nightclub areas are available
- Lounge: receptions of 30-200 or seated dinners for up to 100 guests
- Nightclub: seated dinner of up to 220 and receptions up to 1,300 guests
- Useful for a variety of meeting needs

BOTTLENECK BLUES BAR

- Open to public on Saturdays with live music
- Meetings of up to 150
- Welcome receptions, breakfast, lunch and dinners of up to 275 guests

THE SALTED LIME

- Open to the public for dinner Wednesday – Sunday
- Perfect for meal functions while meeting in the Bottleneck Blues Bar
- Buy-out opportunities available

LANDMARK ATRIUM

- This event space features an open-air concept with natural lighting and brick décor throughout
- Features a ceremony space that can host up to 100 guests
- The main area of the Atrium can accommodate up to 250 guests for a plated meal
- Ideal for large group lunches
- 5 breakout rooms available inside the venue

THE EVENT LAWN/FIRE PIT

- Ideal for outdoor events
- Seats up to 200 guests Theater Style
- Seats up to 150 guests Banquet Style

AMERISTAR CASINO RESORT SPA

RESTAURANTS



BUGATTI'S STEAK & PASTA

Bugatti's features premium steaks cooked to perfection, classic Italian cuisine and seafood favorites. A private 22-seat dining room is available upon request. Open for dinner Wednesday - Saturday.

FIFTH STREET DELI *Located on the casino floor.*

The place to go for a snack or quick meal in the midst of the excitement. Serving up specialty sandwiches, chef-inspired salads, soups, desserts and more.

COPPER WHISK

Start or end your day at this upscale café and bakery. Warm our soul with our in-house baked pastries, or sit with us and enjoy a dish from our flavorful breakfast or lunch menus. Proudly partnered with locally owned Kaldi's Coffee Roasting Co. and Firepot Nomadic Teas, this is the place to be to have a delicious coffee or smoothie.

ASIA *Located on the casino floor.*

Take a culinary excursion through a continent of authentic Asian dishes. *Fresh. Authentic. Delicious.* Open for dinner Thursday - Monday.

KING CAT CLUB

Basque in the classic ambiance of our 1950s-era lounge, where you can enjoy appetizers and a variety of specialty martinis and other beverages. Open in the evenings, Wednesday - Saturday.

THE SALTED LIME

Enjoy a taste of our authentic south of the border cuisine. Featuring street tacos, chimichangas, burritos, and fresh margaritas. Open for dinner Wednesday - Sunday.

GAMING

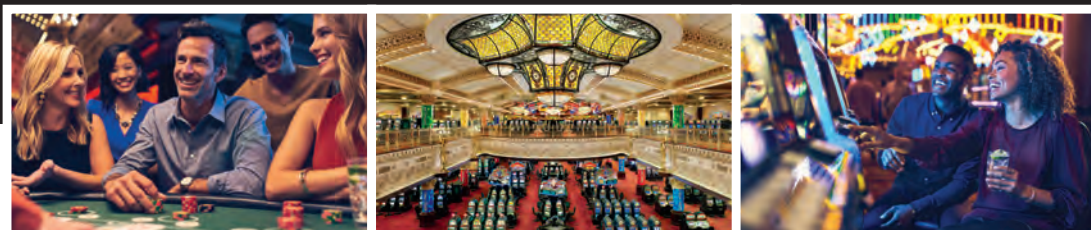

Our spacious casino is one of the country's largest consisting of 130,000 square feet of gaming excitement with a complete selection of popular slots, table games, electronic table games and a lavish poker room.

SLOTS

- More than 1,700 slot and video poker machines
- Exclusive high-limit slot area
- Denominations ranging from one cent to \$100

TABLES

- Enjoy Blackjack, Craps, Baccarat, Roulette, Face Up Pai-Gow, Big Blind Texas Hold'em, and I Luv Suits, just to name a few games we provide.
- Exclusive high-limit table game area
- Great electronic table game options including: Craps, Blackjack, Roulette, Baccarat, and more
- Live poker room

ADDITIONAL

- Fantastic Loyalty program, Boyd Rewards:

Enjoy exceptional rewards like cruises, stays in Las Vegas, Memorable Experiences, and extraordinary annual gifts. Plus, with five tiers and an entire year to earn and enjoy your tier, achieving these great rewards has never been easier.

- Non-smoking on all of Level 2

GREATER ST. LOUIS

AREA ATTRACTIONS



ATTRACTIONS











- Anheuser-Busch St. Louis Brewery
- St. Louis Aquarium at Union Station
- Chicken N Pickle
- Gateway Arch
- Historic Downtown St. Charles
- Lemp Mansion
- Missouri Botanical Garden
- MLB Baseball St. Louis Cardinals – Busch Stadium
- MLS Soccer St. Louis City SC
- Schlafly Bottle Works
- St. Louis Zoo in Forest Park





AMERISTAR[®]

CASINO ★ RESORT ★ SPA

— ST. CHARLES —



- | | | | | | | | |
|---|---------------------|---|---------------------|---|-----------------|---|-----------|
|  | PUBLIC THOROUGHFARE |  | BARS AND LOUNGES |  | BALLROOMS |  | RESTROOMS |
|  | CASINO GAMES |  | SHOPS AND BOUTIQUES |  | SPA AND FITNESS |  | ELEVATORS |
|  | RESTAURANTS |  | BOYD REWARDS | | | | |

One Ameristar Boulevard | St. Charles, MO 63301 | 636.949.7777 | ameristarstcharles.com    

Offer not valid for persons on a Disassociated Patrons, Voluntary Exclusion or Self Exclusion List in jurisdictions which Boyd Gaming operates or who have been otherwise excluded from the participating property. Gambling problem? Call 1-888-BETSOFF. ©2023 Boyd Gaming Corporation®. All Rights Reserved.